

# Safety Toolbox Talk

## Daily Visual Inspections



### When does a DVI need to be done?

- At the start of shift.
- Before the vehicle/equipment is to be used.

### Who is responsible for conducting a DVI?

- Equipment/Vehicle operators are responsible for conducting a DVI on the equipment they are using.
- Superintendents, Foreman, and Leadman are responsible for verifying the DVI has been completed.

### Why are DVIs important?

- Performing a DVI is a proactive approach to the maintenance of the equipment.
- DVIs ensure that all equipment/vehicles are in safe/serviceable conditions.
- When properly done DVIs can reduce the down time of equipment by notifying maintenance of deficiencies.

### What to look for during a DVI?

- Each piece of equipment has a checklist that is to be looked over during a DVI. This list can be found on the DVI app that has been installed on all Kiewit phones or Tablets.
- Common things to look at include fuel/fluid levels, lights, tires/tracks, miscellaneous damage, alarms/horns, safety issues, other issues that could affect the serviceability of the equipment.



Equipment	Category	Pass	Fail
Engine		Pass	Fail
Wheel & Tire		Pass	Fail
Frame & Suspension System		Pass	Fail
Body & Mast Assembly		Pass	Fail
Lights & Electrical		Pass	Fail
Outriggers & Level Jacks		Pass	Fail
Wheel Chocks & Registration		Pass	Fail
Other		Pass	Fail

Attachment +



Daily Plan / Safety



Startup App

Works Connected or  
Disconnected



Operator Conducts DVI

Submits DVI in Connected  
State



Maintenance Supervisor  
reviews Results  
DVI Notification  
Converts to work Order  
Responds to Issues  
PM – Hotlist  
Schedules Mechanic Time



# Mobile DVI Application Sequence

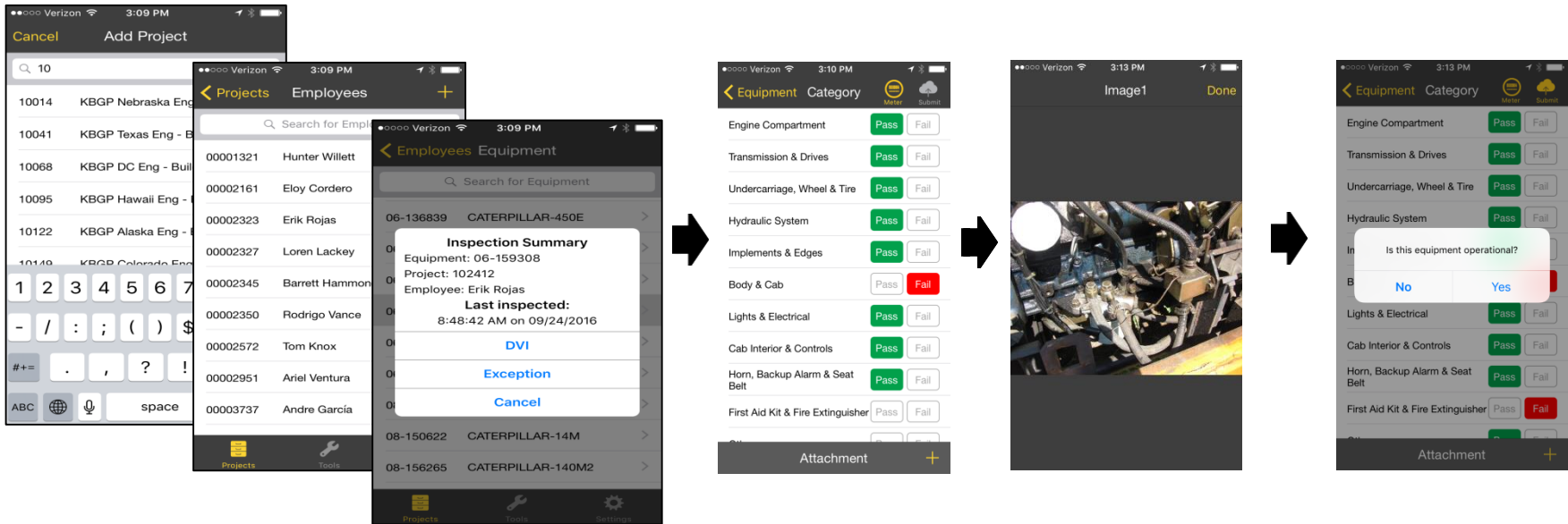

Enter Project, Inspector & Asset to Inspect

Conduct Inspection with Supporting Photos / Comments

Indicate if Equipment Is Ok to Operate & Submit Inspection